

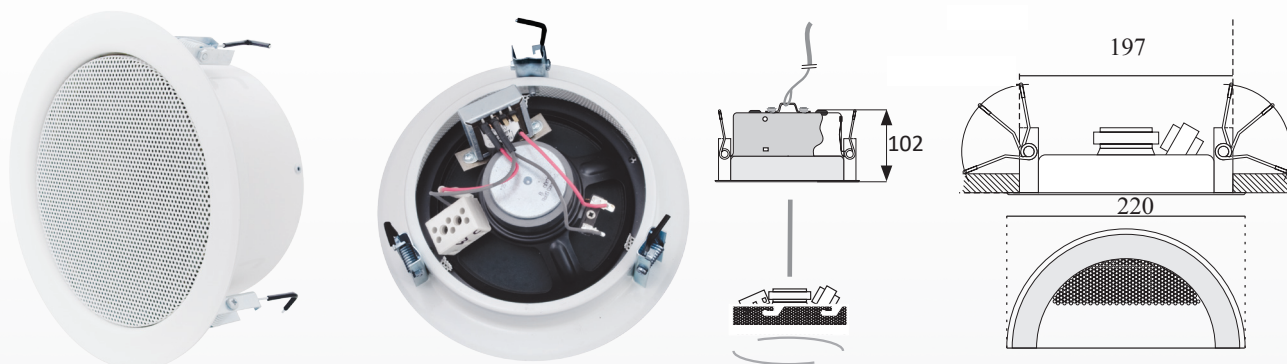

## DELFL 165/10 PP DELFL 165/10 PP1

DELFL 165/10 PP ceiling loudspeaker is ideal for both music and voice evacuation announcements. Due to its good classical design and high quality finish, it may be used in variety of applications such as office buildings, hotels, shopping malls, schools, etc. The DELFL 165/10 PP model, made of powder-coated metal, equipped with a 10 W 165 mm full-range speaker with 100 V transformer, includes also fire dome, 3-pin ceramic block and thermal fuse. Thanks to flat fire dome – just 6 cm high – DELFL 165/10 PP is ideal for installations where the ceiling space is not large. The unique spring mounting with cropped leg springs guarantees a fast ceiling installation. The loudspeaker is painted in standard RAL 9010, but any other RAL color is available as an option. 2 meter metal safe rope capping is available as an option as well. This loudspeaker is optionally offered in PP1 version – it means instead of ceramic block and thermal fuse it is equipped just with a plastic connection block.



Model	DELFL 165/10 PP DELFL 165/10 PP1
Type	ceiling, with fire dome
Application	ceiling/wall
Certificate Number	1438/CPD/0177
Speaker Type	165 mm full-range
Rated power [W]	10
Driver impedance [ $\Omega$ ]	8
Impedance 100V [ $\Omega$ ]	1000/1667/3333/6667
Tappings 100V [W]	10/6/3/1,5
Frequency Range (-10dB) [Hz]	110-16400*
SPL 1W/1 m [dB]	93*
SPL Pmax/1 m [dB]	103*
Sensitivity 1W/4 m EN 54-24 [dB]	82
SPL max (rated noise power/4 m) EN 54-24 [dB]	103,3
Dispersion -6dB, 500 Hz/1 kHz/2 kHz/4kHz [ $^{\circ}$ ]	180/180/90/70
Connection PP/PP1	2x3 pole ceramic cube/ 2x2 pole connector
Temperature range [ $^{\circ}$ C]	<-10, +55>
Type A/B/C	A/C
IP Rating according to EN 54-24 / IP Rating	32
Dimensions [mm]	$\varnothing$ 220x102
Weight with fire dome [kg]	1,6
Material	powder-coated steel panel
Colour	RAL 9010
Packing Unit	12

\* measured in institute other than BIP CNBOP

